

HALL-1

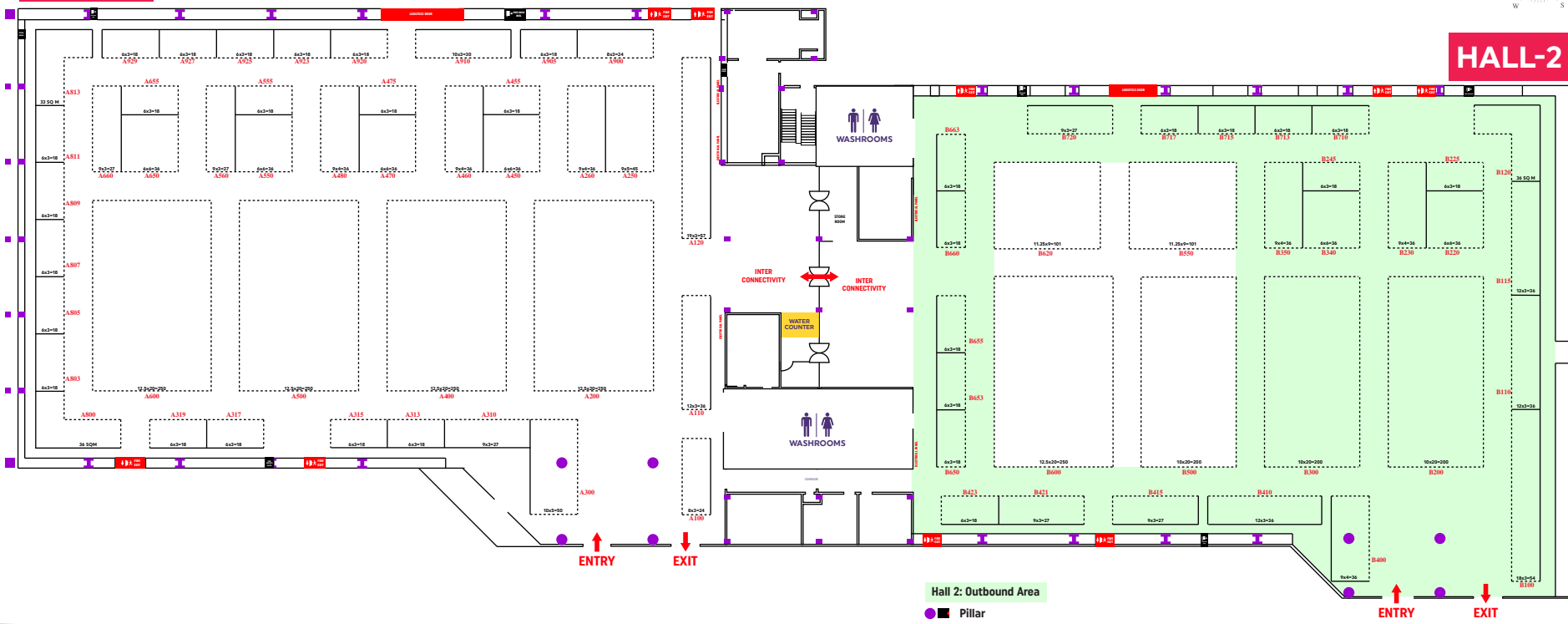

HALL-2

India's Biggest Travel Show Network
TTF
 TRAVEL & TOURISM FAIR
6, 7 & 8 AUGUST 2026
 MAHATMA MANDIR CONVENTION AND EXHIBITION CENTRE,
 GANDHINAGAR, GUJARAT
 EXHIBITION FLOOR PLAN



EXISTING LANDSCAPE

HALL-1B

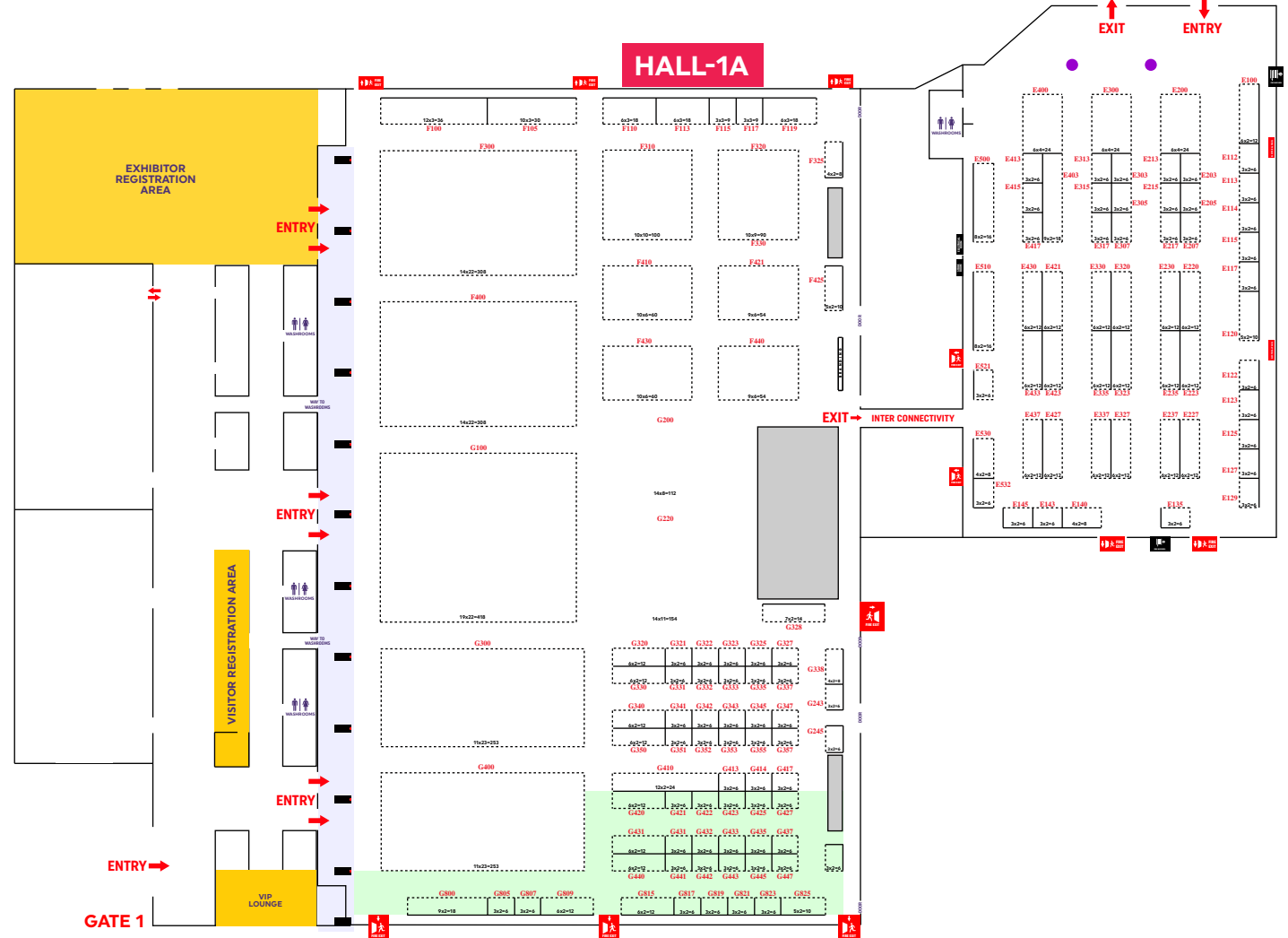

HALL-1C

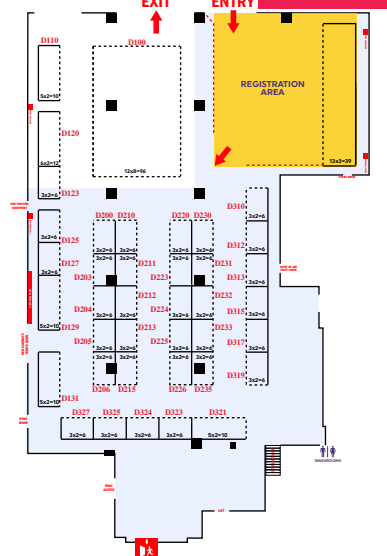

Important note for Hall-1C: Maximum available height of low ceiling area (Hall-1C) for Standard Shell Scheme Booths is 8 feet.

MMCC - BIRDS EYE VIEW PLAN

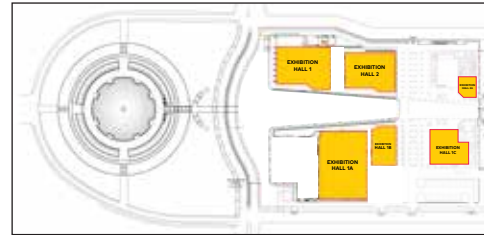

* Fairfest Media Limited reserves right to change the exhibition floor plan/venue & is not responsible for any change due to unforeseen circumstances.

Important note for Hall-1A: Standard Shell Scheme Booths only. Custom Fabrication / Platform is not allowed in Hall-1A.
 Hall 1A: Outbound Area

GATE 3